



STANDARD AND OPTIONAL FEATURES

STANDARD BASE

BRAND	FIAT
CHASSIS TYPE	Cabin chassis
Wide rear wheelbase CCs (1980mm)	S
Weelbase (cm)	380
Standard engine (dcm3)	2,2
Number of cylinders	4
Official power (HP)	7
DIN power (HP)	100
Electric windows	S
Heated electric mirrors	S
Cabin air conditioning	O
Passenger/driver seat with central armrest	S
Heigh-adjustable driver seat	S
Size of tyres	215/70 R15 CP
Central locking cabin	S
ABS	S
Tyre repair kit	S

DIMENSIONS

Length (in cm) +/-2%	637
Width (in cm) +/-2%	230
Height (in cm) +/-2%	309
Height inside (in cm) +/-2%	200

NUMBER OF PLACES

Eating places	4
Berths	5
Seated places	4

WEIGHT

Gross vehicle weight (in kgs)	3300
Unladen weight (in kgs)	2890

AUTONOMY

Fresh water tank +/-5%	130
Waste water tank +/- 5%	80
Waste water anti-freeze	O
Battery loader 16A	S
Auxiliary battery (Ah/20h)	72
Gaz cupboard for 2 bottles 13 kgs	S

MAIN STORAGE HATCHES (HxW)

Rear boot in cm +/-2%	89,5x94,5
Garage en cm +/-2%	/

MAIN STORAGE CAPACITY (in dm³)

Rear compartment bottom bed down +/-5%	405
Rear boot bottom bed put up +/-5%	1330
Rear boot +/-5%	/
Garage +/-5%	/



BERTH DIMENSIONS

Front living room (in cm) +/-4%	105x200
Over-cab bed (in cm) +/-4%	135x200
Permanent rear bed (in cm) +/-4%	/
Bunk beds (en cm) +/-4%	2c 75x190

EXTERIOR

Polyester sandwich roof	S
Styrofoam insulation all walls	S
Aluminium sandwich panel	S
Insulated sandwich floor 36 mm thick	S
Grey aluminium rocker panel	S
Grey rear bumper ABS	S
Manual retractable entrance step	S
Retractable electric entrance step	O
Polyplastic bay window 4-23	S
HEKI 3 panoramic sunroof	O
MIDI HEKI Sunroof	/
Screened skylight	S
Screen on cell door	O
Outside lighting	O
Boot with outside access	S

KITCHEN

2-ring stainless steel stove	S
Fridge (capacity in L)	97
Rectangular stainless steel sink	S
Spices rack	S

BATHROOM

removable WC cassette (type C200)	S
Separate shower	S
Transparent bathroom skylight	S

HEATING / INSULATION

Truma SL3002 heater (and boiler 10 liters)	S
Insulated screen with air vents	S

COMFORT / SAFETY

TV fixture 12V/220V/Coaxial	S
3 point seatbelt facing road	S
2 point seatbelt facing back	O
Pre-mounted radio (antenna + 2 loudspeakers)	O
Driver and passenger seats on swivel base	O
Cabin seat covers	O
Power box and loader 16A	S
12V/220V plug	S
Wardrobe + boot lighting	O
Cabin carpet	1/2 carpet
Cell carpet	O
Berth in front living-room	S
Permanent bed on slatted bed base	S

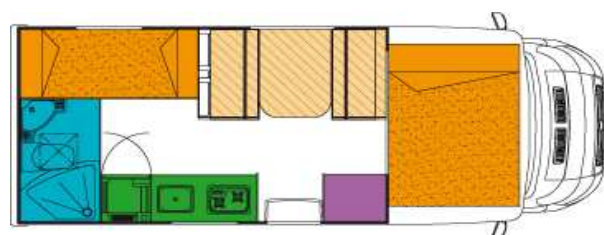

S : Standard O : Option - : Impossible or not planned